

- Swing check valves
- 640 AA
- PN 10-40
- DN 50-250



**Range of application**

Admissible operating pressure [bar] at design temperature [°C] <sup>1)</sup>

Material	PN	-10	20	120	150	200	250	300	350	400
<b>1.0619</b>	<b>10-16</b>	16	16	16	15	14	13	11	10	8
	<b>25</b>	25	25	25	23	22	20	17	16	13
	<b>40</b>	40	40	40	37	35	32	28	24	21

1) Operating temperature = design temperature minus temperature surcharge acc. to DIN regulations.

---

**■ Swing check valves ■ 640 AA ■ PN 10-40 ■ DN 50-250****Version**

- Body cast steel
- Available with flange and buttweld ends

**Pressure and temperature ratings**

- Pressure rating up to 40 bar
- Temperature rating up to 400 °C

**Materials**

- 1.0619

Further materials on request

**Media**

Depending on the material swing check valves are suitable for water, gas, oil and other non aggressive media

**Fields of application**

Chemical industries, power plants, ship building and other

---

**Design Highlights**

- Hard faced integral body seat with 13 % Cr-Steel or 17 % Cr-Steel layer
- Shut-off disc with curved journal within lever
- The lever rests on the hinge pin by means of a separate bearing bush

**Benefits**

- Extremely resistant to wear
- To improve movability and therefore to improve the alignment of the disc to the body seat
- Improved resistance to wear by means of proper material selection

▪ Swing check valves ▪ 640 AA ▪ PN 10-40 ▪ DN 50-250

**Flange-Version**

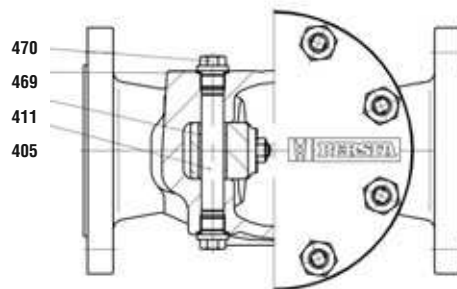
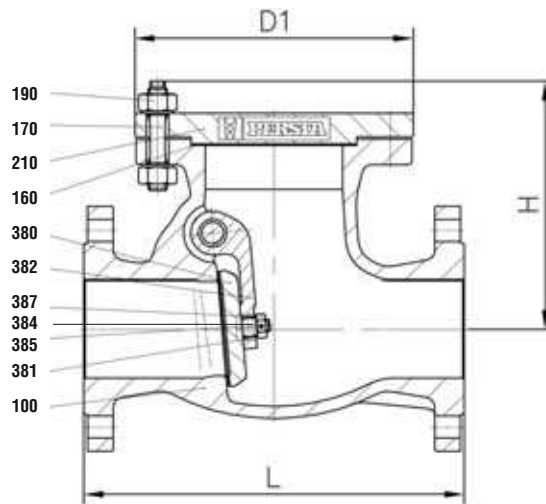

**BW-Version**

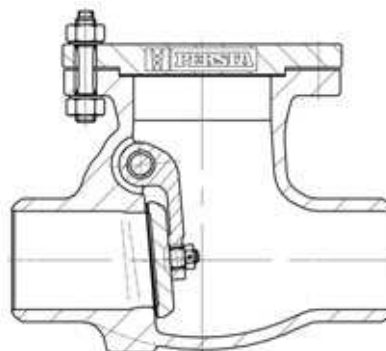

■ Swing check valves ■ 640 AA ■ PN 10-40 ■ DN 50-250

**Materials**

Pos.	Component	1.0619 (11)
100	Body welded on with	1.0619 Cr17
160	▶ Gasket	Graphite <sup>2)</sup>
170	Screw bolt	1.1181
190	Hexagonal nut	1.1181
210	Cover	1.0460
380	▶ Disc welded on with	1.4021 <sup>1)</sup>
382	▶ Hinge	1.0425
384	▶ Bushing	1.4006
385	▶ Pint	1.4370
387	▶ Hexagonal nut	1.1181
405	▶ Hinge pin	1.4021
411	▶ Guide bushing	1.4006
469	▶ Gasket	2.4066
470	Screw plug	1.7709
	▶ Spare parts	
	Further materials on request. 1) ≥ DN 125 1.0460 welded on with Cr17 2) ≥ DN 150 grooved with graphite layer	

**Dimensions/mm**

DN	L	H	D
50	230	165	172
65	290	185	212
80	310	210	227
100	350	225	257
125	400	255	292
150	480	310	327
200	600	370	412
250	730	435	462

**Weights/kg and Kvs-values**

DN	FL	BW	Kvs (m <sup>3</sup> /h)
50	19	13	
65	31	23	170
80	36	27	256
100	52	39	400
125	70	53	625
150	104	82	900
200	146	108	1600
250	289	249	2500

- Swing check valves
- VALTRA Swing check valve
- 640 AA
- PN 10-40
- DN 300-800



**Range of application**

Admissible operating pressure [bar] at design temperature [°C] <sup>1)</sup>

Material	PN	-10	20	100	120	200	250	300	350	400
P265GH	10	10	10	10	10	9	8	7	6	5
	16	16	16	16	16	14	13	11	10	8
	25	25	25	25	25	22	20	17	16	13
	40	40	40	40	40	35	32	28	24	21

1) Operating temperature = design temperature minus temperature surcharge acc. to DIN regulations.

---

▪ **Swing check valves** ▪ **VALTRA Swing check valve** ▪ **640 AA** ▪ **PN 10-40** ▪ **DN 300-800**

**Standard features**

- Disc with inside shaft
- Body pressed-plate welding construction
- Available with flange and buttweld ends

**Pressure and temperature ratings**

- Pressure rating up to 40 bar
- Temperature rating up to 400 °C

**Material**

- P265GH

Further materials on request

**Media**

Depending on the material swing check valves are suitable for water, gas, oil and other non aggressive media

**Fields of application**

Chemical industries, power plants, ship building and other

---

**Design Highlights**

- Body- and disc seat welded on
- Disc with flexible shaft at the hinge
- Lever rests on the hinge pin by means of a separate bushing
- Inside shaft

**Benefits**

- Extremely resistant to wear
- Optimum alignment of the disc to the body seat
- Improved resistance wear by means of an optimal material selection
- Limited leakage due to less sealings

▪ Swing check valves ▪ VALTRA Swing check valve ▪ 640 AA ▪ PN 10-40 ▪ DN 300-800

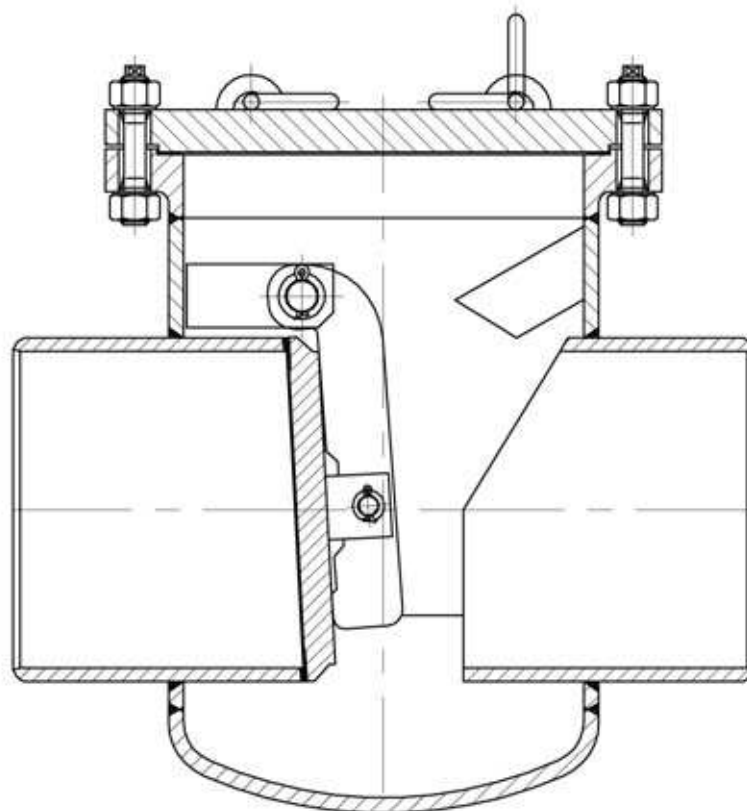
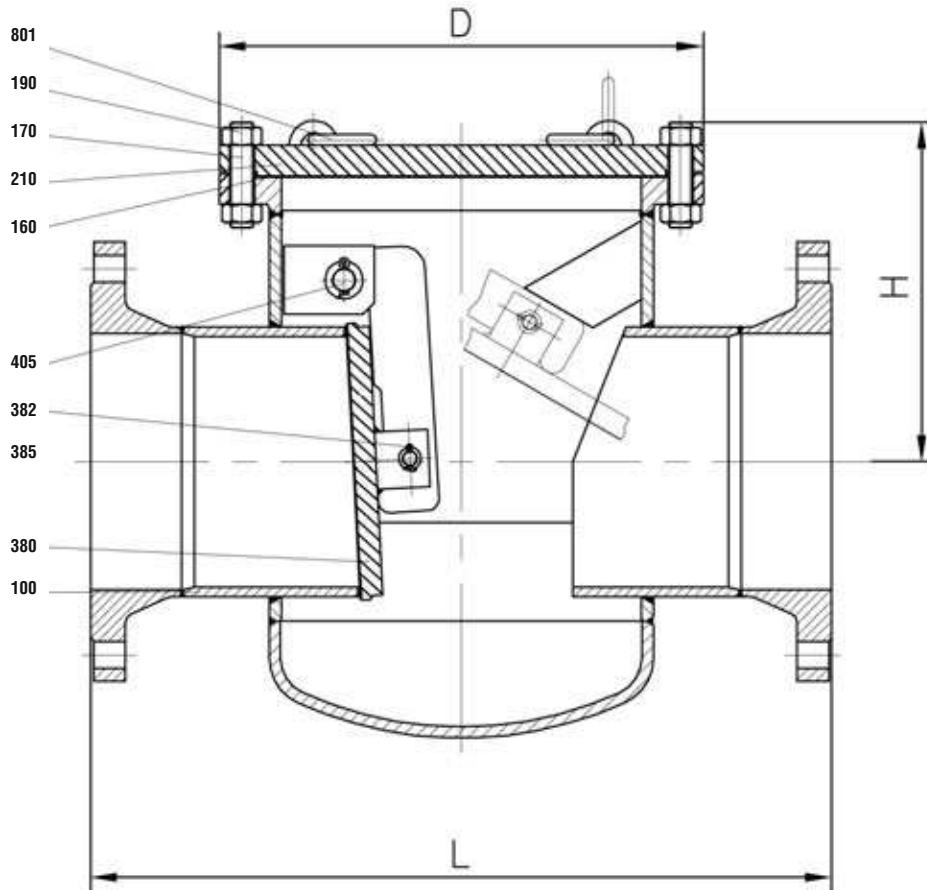

**■ Swing check valves ■ VALTRA Swing check valve ■ 640 AA ■ PN 10-40 ■ DN 300-800**
**Materials**

Pos.	Component	P265GH (22)
100	Body welded on with	P265GH X20CrMo171
160	▶ Gasket	1.4541/Graphite
170	Screw bolt	1.7158
190	Hexagonal nut	1.7158
210	Cover	P265GH
380	▶ Disc welded on with	P265GH X8CrTi18
382	▶ Hinge	S235JRG2
384	▶ Bushing	GG 25
385	▶ Pint	A2-70
405	▶ Hinge pin	1.4021
801	Lifting eye bolt	S355J2G3
	▶ Spare parts	
	Further materials on request.	

**Dimensions/mm**

DN	PN 10-16		PN 25		PN 40		PN 10-16		PN 25		PN 40	
	L	L	H	H	H	H	D	D	D	D	D	D
<b>300</b>	700	850	385	415	435	525						525
<b>350</b>	800	980	430	450	485	630						640
<b>400</b>	900	1100	500	540	595	745						755
<b>500</b>	1100	1250	585	615	670	870	870					890
<b>600</b>	1300	1450				1040						1040
<b>700</b>												
<b>800</b>												

**Weights/kg and Kvs-values**

DN	PN 10		PN 16		PN 25		PN 40		Kvs (m3/h)
	FL	FL	FL	FL	BW	BW	BW	BW	
<b>300</b>	275	285	350	430	255	255	305	355	3600
<b>350</b>	380	395	475	550	335	345	395	445	4900
<b>400</b>	560	575	735	895	525	525	365	745	6400
<b>500</b>	910	945	1180	1300	860	860	1040	1125	9996
<b>600</b>									14395
<b>700</b>									19593
<b>800</b>									25591



▪ Swing check valves ▪ 640 AA ▪ PN 63-160 (PD 18) ▪ DN 50-300/250



**Range of application**

FL- Version Material	PN	Admissible operating pressure [bar] at design temperature [°C] <sup>1)</sup>															
		-10	20	120	150	200	250	300	350	400	450	500	510	520	530	540	550
1.5415	63	63	63	63	63	63	63	53	50	47	45	29	22	16	14		
1.7335	63	63	63	63	63	63	63	63	61	58	56	47	40	32	25	20	15
1.7383	63	63	63	63	63	63	63	63	61	58	56	47	40	32	28	24	20

1) Operating temperature = design temperature minus temperature surcharge acc. to DIN regulations.

FL- Version Material	PN	Admissible operating pressure [bar] at design temperature [°C] <sup>1)</sup>															
		-10	20	120	150	200	250	300	350	400	450	500	510	520	530	540	550
1.5415	100	100	100	100	100	100	87	78	74	70	45	34	27	22			
1.7335	100	100	100	100	100	100	95	91	87	74	62	49	38	31	24		
1.7383	100	100	100	100	100	100	95	91	87	74	62	49	43	37	31		

1) Operating temperature = design temperature minus temperature surcharge acc. to DIN regulations.

FL- Version Material	PN	Admissible operating pressure [bar] at design temperature [°C] <sup>1)</sup>															
		-10	20	120	150	200	250	300	350	400	450	500	510	520	530	540	550
1.5415	160	160	160	160	160	160	139	125	118	112	72	55	43	35			
1.7335	160	160	160	160	160	160	153	146	139	118	100	79	62	46	35		
1.7383	160	160	160	160	160	160	153	146	139	118	100	79	70	61	52		

1) Operating temperature = design temperature minus temperature surcharge acc. to DIN regulations.

BW- Version Material	PD	Admissible operating pressure [bar] at design temperature [°C] <sup>1)</sup>																									
		120	150	200	250	300	350	400	420	430	440	460	470	480	490	500	510	520	530	540	550	560	570	580	590	600	
1.5415	18	219	204	185	170	146	141	136	134	133	132	130	129	128	112	88	67	53	42								
1.7335	18	228	219	205	194	180	170	161	156	155	153	150	149	148	147	133	112	89	72	58	46	37	30				
1.7383	18	233	224	210	205	194	180	170	166	164	262	159	156	155	153	131	115	100	88	76	66	56	50	43	37	33	

1) Operating temperature = design temperature minus temperature surcharge acc. to DIN regulations.

▪ **Swing check valves** ▪ **640 AA** ▪ **PN 63-160 (PD 18)** ▪ **DN 50-300/250**

**Standard features**

- Die-forged body
- Disc with inside shaft
- Fastening of the disc at the cover
- Available with flange and buttweld ends

**Pressure and temperature ratings**

- Pressure rating BW-Ends up to 233 bar (PD 18)
- Pressure rating FL up to 160 bar
- Temperature rating up -10 °C to 600 °C

**Materials**

- 1.5415
- 1.7335
- 1.7383

Further materials on request

**Media**

Depending on the material swing check valves are suitable for water, gas, oil and other non aggressive media

**Fields of application**

Chemical industries, power plants, ship building and other

**Design Highlights**

- Die-forged body
- Integral seat
- Lever rests on the hinge pin by means of the guide bush
- Bolted bonnet with reduced-shaft bolts
- Fastening of the disc at the cover

**Benefits**

- Free from porosity and shrink holes
- No contact corrosion
- Optimum adjustment of the disc to the body seat by means of the movability the guide bushing
- To improve the stress capacity when temperature and pressure changes
- Easy to assemble and disassemble

▪ Swing check valves ▪ 640 AA ▪ PN 63-160 (PD 18) ▪ DN 50-300/250

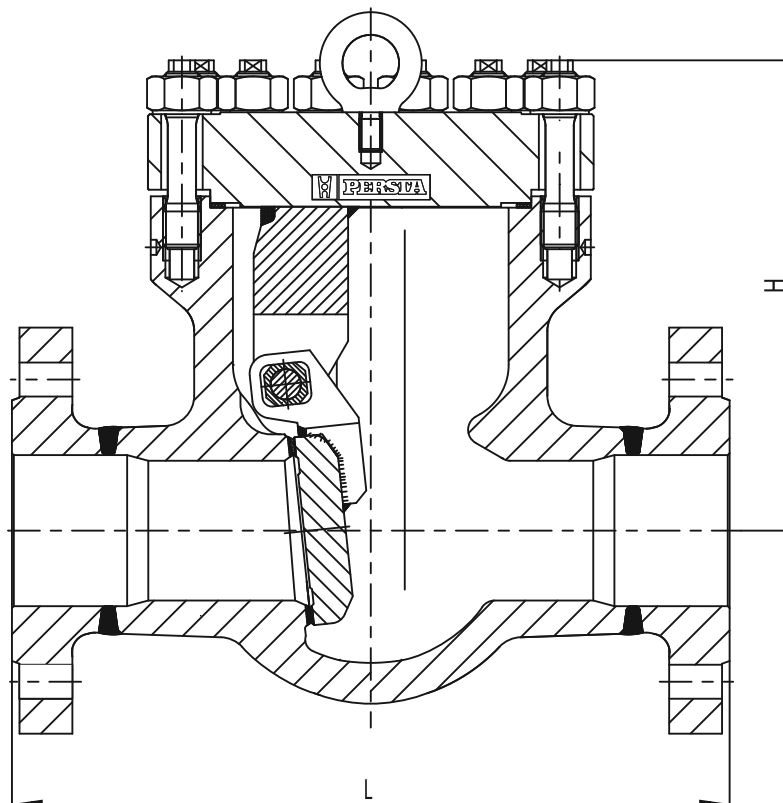
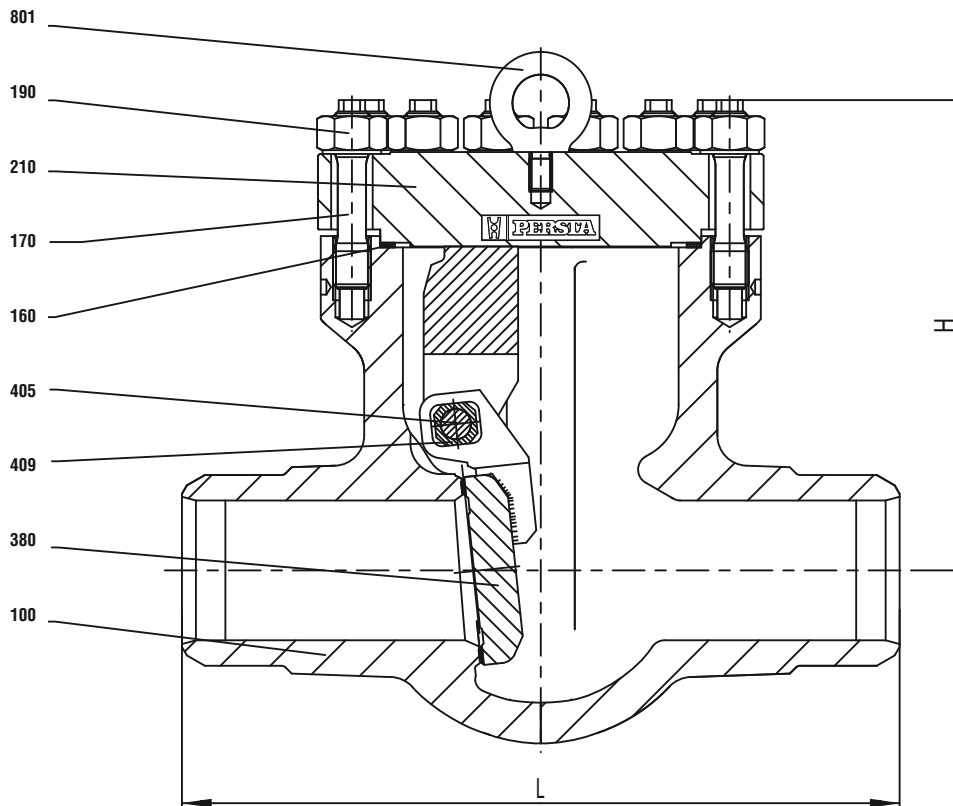

**■ Swing check valves ■ 640 AA ■ PN 63-160 (PD 18) ■ DN 50-300/250**
**Materials**

Pos.	Component	1.5415 (42)	1.7335 (44)	1.7383 (45)
100	Body welded on with	1.5415 Stellite	1.7383/1.7335 Stellite	1.7383 Stellite
160	▶ Gasket	Graphite	Graphite	Graphite
170	Screw bolt	1.7709	1.7709	1.7709
190	Hexagonal nut	1.7218	1.7218	1.7218
210	Cover	1.5415	1.7335	1.7383
380	▶ Disc welded on with	1.5415 Stellite	1.7335 Stellite	1.7383 Stellite
405	▶ Hinge pin	1.4021	1.4021	1.4021
409	▶ Guide bush	0.7040	0.7040	0.7040
801	Lifting eye bolt	1.0401	1.0401	1.0401
	▶ Spare parts			

**Dimensions/mm**

DN	PN		H	D
	63-100 L	160 L		
50	250	300	220	192
65 / 50	340	360	220	192
80	380	390	280	236
100	430	450	320	265
125 / 100	500	525	320	265
150	550	600	410	350
200	650	750	510	440
250	775	900	595	550
300 / 250	900	1050	595	550

**Weights/kg**

DN	FL	BW
50	45	35
65 / 50	53	43
80	83	63
100	105	100
125 / 100	111	106
150	270	220
200	425	365
250	525	750
300 / 250	610	800